

# Havelpromenade Grundrisse

## Wohnung 5.15.2.

3 Zimmer

Erdgeschoss

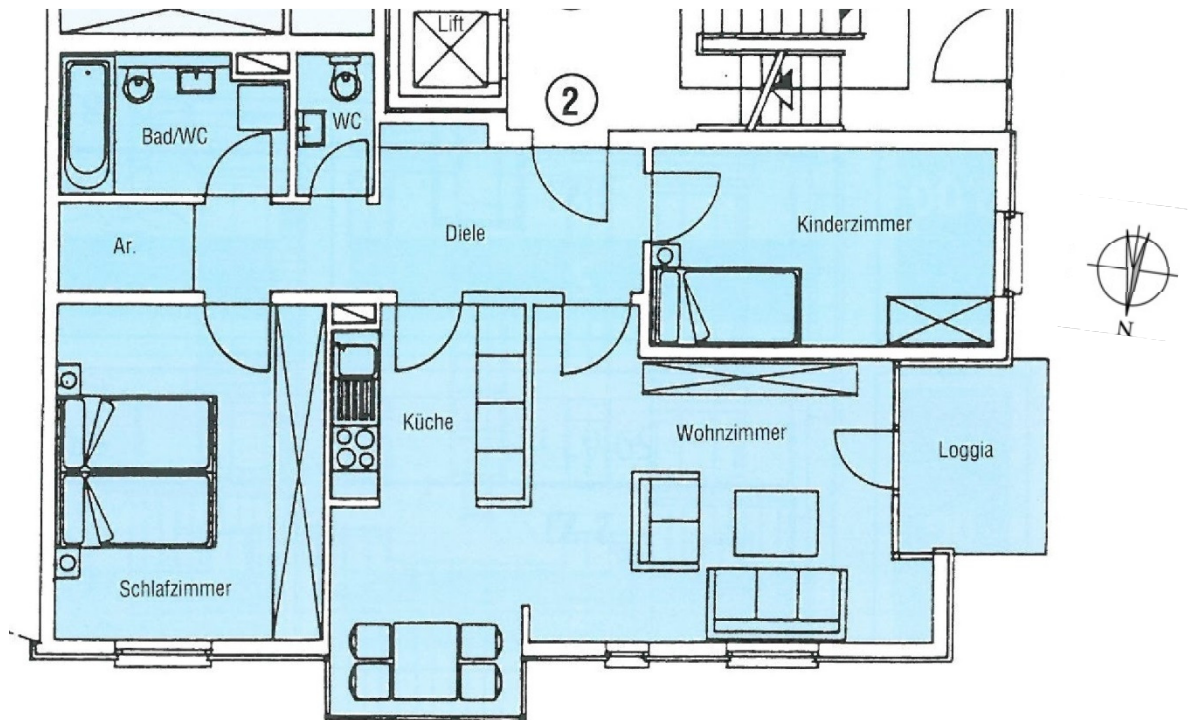
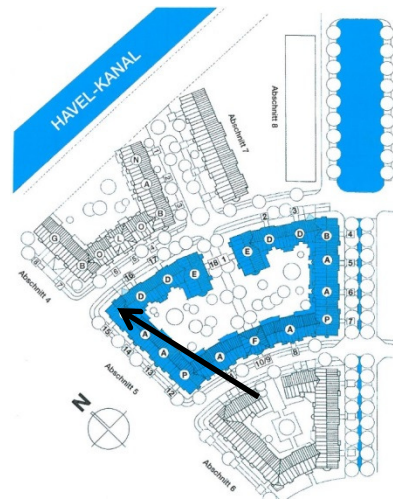

<b>3 ZIMMER</b>	<b>m<sup>2</sup></b>
WOHNZIMMER	19,02
SCHLAFZIMMER	15,18
KINDERZIMMER	11,61
KÜCHE	13,25
BAD/WC	5,40
WC	1,90
DIELE	9,85
ABSTELLRAUM	1,99
LOGGIA (1/2)	2,51
ABZÜGL. 3 % PUTZ	-2,42
<b>WOHNFLÄCHE</b>	<b>78,29</b>

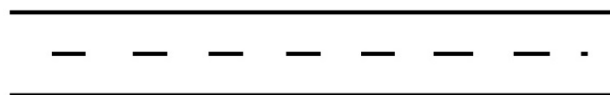

Ahorring 33c